

NOTICE OF INCORPORATION ELECTION FOR THE CITY OF LAKE POINT

A Request for a Feasibility Study into the proposed City of Lake Point was received in the Lieutenant Governor’s office on August 28, 2021.

The full request and feasibility study summary can be seen at: voteinfo.utah.gov/lakepoint

Proposition #16 – Map of the Proposed Incorporation of Lake Point*

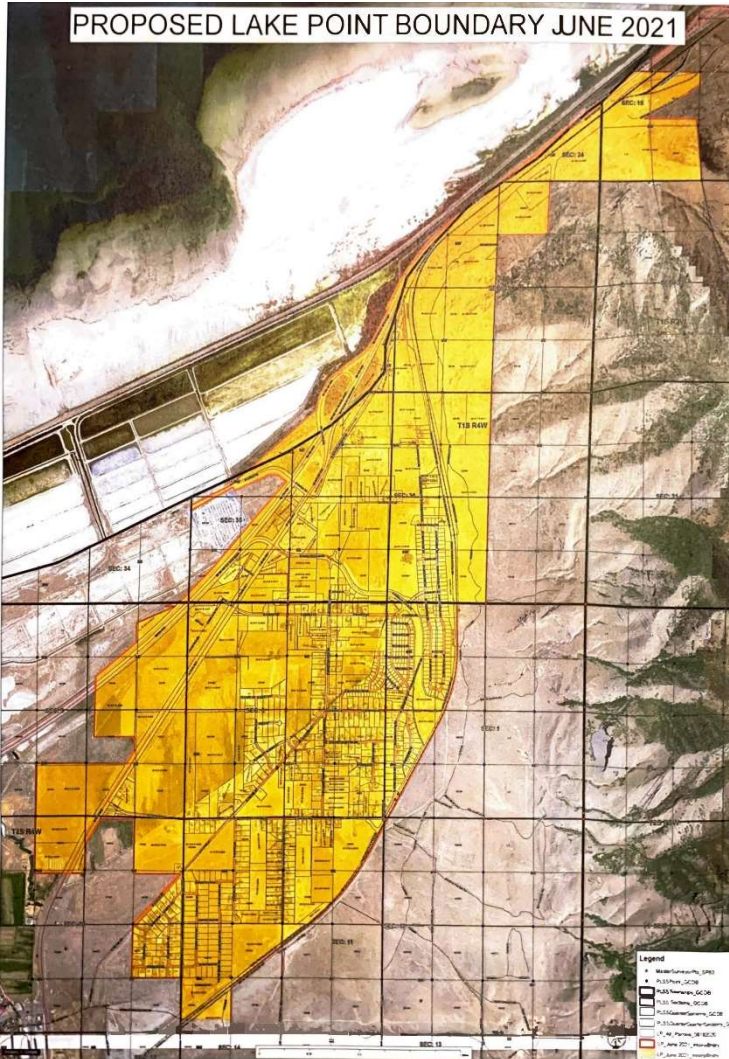

This proposition will be on the November 2, 2021 General Election. By-Mail Ballots will be sent to all voters within the proposed incorporation area by the 12th of October.

***DISCLAIMER:** This map is accurate as of the time of printing. **The insert included with your ballot is incorrect.** For an up-to-date map of the proposed incorporation area of Lake Point, please visit voteinfo.utah.gov/lakepoint.

There will be **in-person polling locations** from 7am to 8pm on Election Day at:

- Deseret Peak Complex &
- Tooele County Admin Building

These locations are specifically for the disabled, people who did not receive a ballot in the mail, whose information is incorrect, or other emergencies. However, everyone is welcome. You will receive a paper ballot, exactly like the one you received in the mail. There will be a place you can sit and fill out your ballot and then drop it off in a ballot drop box located on site.

Voted ballots may be returned 1 of 3 ways:

By ballot drop boxes: (by 8pm November 2, 2021)

- Grantsville Box: East of GV City Hall next to utility box
- Stansbury Park Box: 500 E Village Blvd (across from Hug-Hes)
- Tooele City Hall: South of Tooele City Hall, next to utility box
- Tooele County: Alley behind Tooele County Administration Building

For a map showing the location of the ballot boxes, go to:
Tooeleco.org > Your Government > Clerk > Elections > Where do I Vote? > Ballot Drop Box Maps

By mail
(Postmarked by November 1, 2021)

In person, Clerk’s office
(by 8pm November 2, 2021)