

**When recorded, return to:**

Tooele County  
47 South Main Street  
Tooele, Utah 84074

**TOOELE COUNTY CORPORATON**  
**CONTRACT # 21-04-07**

Affecting Parcel No. 05-083-0-0005

**PERPETUAL EASEMENT FOR PUBLIC ROAD**

MIKE AUSTIN and SARAH AUSTIN, as Trustees of the Mike and Sarah Austin Family Trust dated February 14, 2020, for good and valuable consideration, hereby grant to Tooele County, a political subdivision of the State of Utah, a 30-foot wide perpetual easement for a public road, lying within the confines of West Canyon Road, located in Section 34, Township 2 South, Range 6 West, SLBM, Tooele County, Utah, and particularly described in attached Exhibit (pages 1 and 2).

DATED this 9th day of April, 2021.



Mike Austin, Trustee

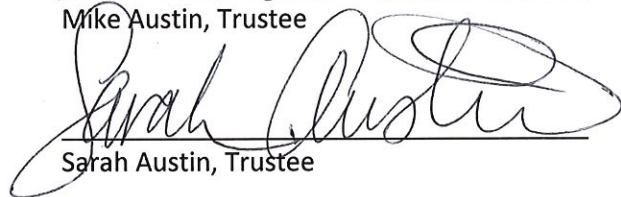

Sarah Austin, Trustee

The foregoing Perpetual Easement for Public Road was acknowledged before me this 9th day of April, 2021, by Mike Austin and Sarah Austin, Trustees of the Mike and Sarah Austin Family Trust dated February 14, 2020.

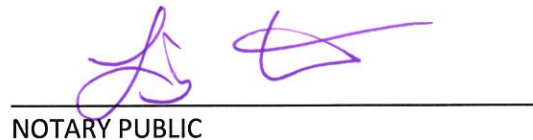
  
NOTARY PUBLIC

Accepted by Tooele County:

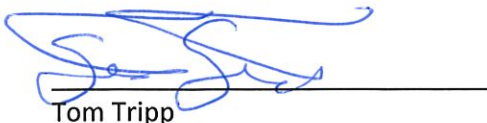

Tom Tripp  
Chair, Tooele County Council



Jerry Houghton, Tooele County Recorder

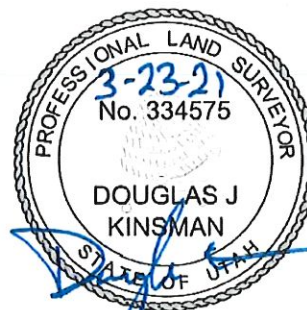

### HORIZONTAL GRAPHIC SCALE



( IN FEET )

HORZ: 1 inch = 200 ft.

N 89°44'11" E 2643.50' (CALCULATED)

PROJECT# DATE  
T1329A 3/23/21

1 OF 1

ト列上:

**WEST CANYON ROAD**

EXHIBIT A, PAGE 1

GRANTSVILLE, UTAH 84029  
EXHIBIT "B"

F52

**TOOELE COUNTY**  
1600 WEST K AVENUE  
TOOELE, UTAH 84074  
801-560-1147

169 N. Main Street, Unit 1  
Tooele, Utah 84074  
Phone: 435.843.3590  
Fax: 435.578.0108  
[www.ensignutah.com](http://www.ensignutah.com)



**ENSIGN**



### Road Description

A parcel of land, situate in the North Half of Section 34, Township 2 South, Range 6 West, Salt Lake Base and Meridian, Tooele County, Utah, more particularly described as follows:

Beginning at a point on the Section line, said point being North 89°43'11" East 420.65 feet along the section line from the North Quarter Corner of Section 34, Township 2 South, Range 6 West, Salt Lake Base and Meridian, and running:

thence North 89°43'11" East 30.17 feet along said section line;  
thence Southerly 66.48 feet along the arc of a 165.00 feet radius non-tangent curve to the right (center bears North 84°50'01" West and the long chord bears South 16°42'35" West 66.03 feet through a central angle of 23°05'11"); to a point of reverse curvature;  
thence Southwesterly 52.62 feet along the arc of a 535.00 feet radius tangent curve to the left (center bears South 61°44'50" East and the long chord bears South 25°26'07" West 52.60 feet through a central angle of 05°38'06");  
thence South 22°37'03" West 177.68 feet;  
thence Southwesterly 715.52 feet along the arc of a 3,494.33 feet radius non-tangent curve to the right (center bears North 67°52'37" West and the long chord bears South 27°59'21" West 714.27 feet through a central angle of 11°43'56") to the Quarter Section Line;  
thence North 0°21'39" West 54.53 feet along said line;  
thence Northeasterly 664.65 feet along the arc of a 3,245.88 feet radius non-tangent curve to the left (center bears North 56°29'17" West and the long chord bears North 27°38'45" East 663.49 feet through a central angle of 11°43'56");  
thence North 22°37'03" East 177.68 feet;  
thence Northeasterly 55.57 feet along the arc of a 565.00 feet radius tangent curve to the right (center bears South 67°22'57" East and the long chord bears North 25°26'07" East 55.55 feet through a central angle of 05°38'06"); to a point of reverse curvature;  
thence Northerly 51.53 feet along the arc of a 135.00 feet radius tangent curve to the left (center bears North 61°44'50" West and the long chord bears North 17°19'02" East 51.22 feet through a central angle of 21°52'15"), to the Point of Beginning.

Contains 29,080 square feet or 0.67 acres.

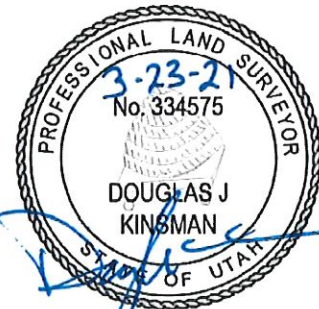

EXHIBIT A, PAGE 2