

ORDINANCE 2018-02

AN ORDINANCE AMENDING THE OFFICIAL ZONING MAP OF TOOELE COUNTY; REZONING APPROXIMATELY 6.39 ACRES OF LAND, ON THE NORTHEAST CORNER OF DROUBAY ROAD AND ERDA WAY, FROM RR-5 TO RR-1 ZC

NOW, THEREFORE, BE IT ORDAINED BY THE LEGISLATIVE BODY OF TOOELE COUNTY, UTAH AS FOLLOWS:

SECTION I – AMENDMENT. Pursuant to Utah Code Annotated Sections 17-27a-502 and 17-27a-503, the Tooele County Planning Commission conducted a public hearing on the application for rezone submitted by Alyssa Coombs on behalf of Lynn and Michaela Falkner and recommended it be denied.

Notice having been provided as required by UCA Subsection 17-27a-205(1)(b) and having held a public meeting, the official zoning map of Tooele County is hereby amended by changing the zoning designation of approximately 6.39 acres, known as Parcel 10-029-J-0001, located at 4008 N. Droubay Road in Erda, Tooele County, Utah from RR-5 (Rural Residential, Five-Acre Minimum Lot Size) to RR-1 (Rural Residential, One-Acre Minimum Lot Size) with the zoning condition that the subject property is limited to one dwelling unit per 2.5 acres.

Maps showing the area of the rezone are attached hereto and by this reference made a part hereof.

SECTION II – REPEALER. Ordinances and resolutions in conflict herewith are hereby repealed to the extent of such conflict.

SECTION III – EFFECTIVE DATE. This ordinance shall become effective fifteen (15) days after its passage, provided it has been published, or at such publication date if more than fifteen (15) days after passage.

Ord. 2018-02

IN WITNESS WHEREOF the Tooele County Commission, which is the legislative body of Tooele County, passed, approved, and enacted this ordinance this 3rd day of April 2018.

ATTEST:

TOOELE COUNTY COMMISSION:

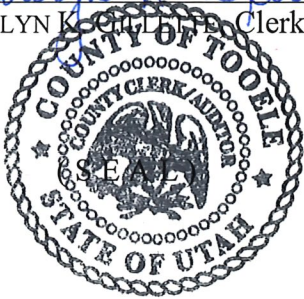

Marilyn K. Gullett, Clerk/Auditor

WADE B. BITNER, Chairman



Commissioner Bateman voted aye
Commissioner Bitner voted aye
Commissioner Milne voted aye

APPROVED AS TO FORM:

SCOTT A. BROADHEAD
Tooele County Attorney

REZ 2018-01: Rezone from RR-5 (Rural Residential, 5 Acre Min.) to RR-1 (Rural Residential, 1 Acre Min.)

4008 North Droubay Road (Parcel #10-029-J-0001)

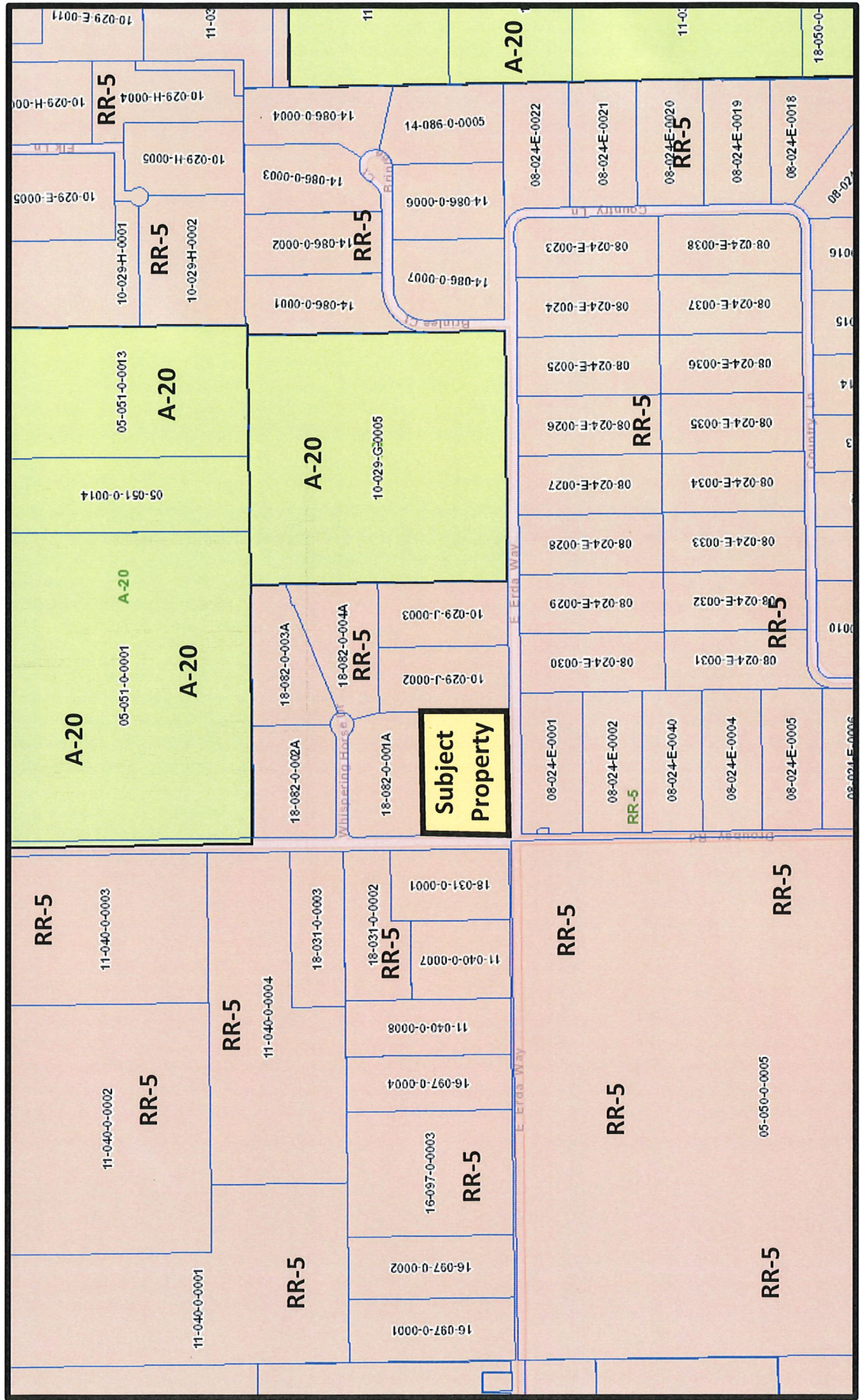

REZ 2018-01: Rezone from RR-5 (Rural Residential, 5 Acre Min.) to RR-1 (Rural Residential, 1 Acre Min.)

4008 North Droubay Road (Parcel #10-029-J-0001)

