

ORDINANCE 2015-19

AN ORDINANCE VACATING THE PUBLIC RIGHT-OF-WAY INTEREST IN 7C LANE, LOCATED DIRECTLY SOUTH OF CHURCH ROAD AND WEST OF SR-36 IN ERDA

NOW, THEREFORE, BE IT ORDAINED BY THE LEGISLATIVE BODY OF TOOELE COUNTY, UTAH AS FOLLOWS:

SECTION I – PURPOSE. Janice Clegg, et al., petitioned the Tooele County Planning Commission to vacate the public’s interest in the road located within their four-lot family subdivision which would make it a private lane. The Tooele County Planning Commission held a public hearing on the issue and recommends passage of this ordinance.

SECTION II – ROAD VACATED. Having provided proper notice pursuant to Utah Code Annotated 72-3-108, a public hearing was conducted, and finding good cause therefore, Tooele County hereby vacates the public right-of-way interest in 7C Lane (350 East) which is part of the 7C Subdivision Amended, as depicted on the plat attached hereto as Exhibit A and, by this reference, made a part hereof. The road is located in Erda directly south of Church Road (4800 North) and directly west of SR-36 in the Southeast Quarter of Section 28, Township 2 South, Range 4 West, Salt Lake Base & Meridian.

The County’s interest in the vacated road is reapportioned amongst the parcels that front 7C Lane. It is now a private road and will not be maintained by Tooele County.

A map showing the area of the road being vacated is attached hereto as Exhibit B and, by this reference, made a part hereof.

The Tooele County Clerk is hereby directed to cause this ordinance to be recorded in the office of the County Recorder/Surveyor.

SECTION III - REPEALER. Ordinances and resolutions in conflict herewith are hereby repealed to the extent of such conflict.

Ord. 2015-19

SECTION IV - EFFECTIVE DATE. This ordinance shall become effective 15 days after its passage provided it has been published, or at such publication date if more than 15 days after passage.

IN WITNESS WHEREOF the Tooele County Commission, which is the legislative body of Tooele County, passed, approved, and enacted this ordinance this 17th day of November 2015.

ATTEST:

TOOELE COUNTY COMMISSION:

Marilyn K. Gillette, Clerk/Auditor

WADE B. BITNER, Chairman

(S E A L)

Commissioner Bateman voted aye
Commissioner Bitner voted aye
Commissioner Milne voted aye

APPROVED AS TO FORM:



SCOTT A. BROADHEAD
Tooele County Attorney

EXHIBIT A

EXHIBIT B

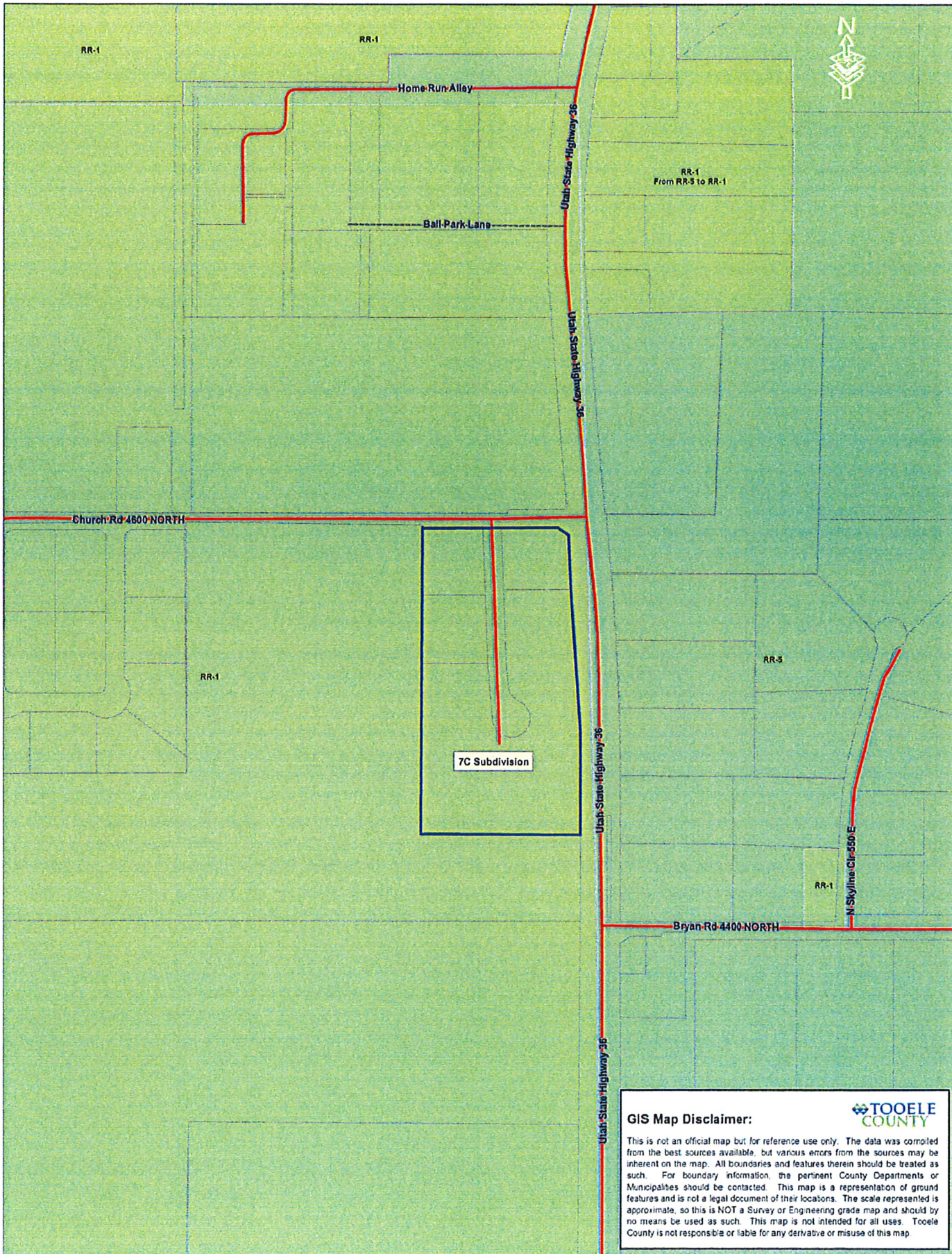

GIS Map Disclaimer:

This is not an official map but for reference use only. The data was compiled from the best sources available, but various errors from the sources may be inherent on the map. All boundaries and features therein should be treated as such. For boundary information, the pertinent County Departments or Municipalities should be contacted. This map is a representation of ground features and is not a legal document of their locations. The scale represented is approximate, so this is NOT a Survey or Engineering grade map and should by no means be used as such. This map is not intended for all uses. Tooele County is not responsible or liable for any derivative or misuse of this map.

